

Step-by-Step Picture Guide to Seamlessly Splicing Art Spectrum Colourfix Papers

to create larger sheets on which to begin a painting—
or to add area to painting-in-progress
when composition requires

by Donna Aldridge PSA M-MAPS©2001

www.aldrigestudios.com/writings for more info

MATERIALS:

- 2 SHEETS OF SAME COLOR ART SPECTRUM COLOURFIX PAPER
---OR COLOURFIX PAINTING-IN-PROGRESS PLUS MATCHING PARTIAL SHEET
- ART SPECTRUM COLOURFIX PRIMER IN COLOR MATCHING PAPER
- PH-BALANCED FOAM-CORE BOARD OR MUSEUM BOARD FOR BACKING
- 3M SUPER 77 SPRAY CONTACT CEMENT OR OTHER NON-WETTING ADHESIVE
- KNIFE WITH FRESH, SHARP BLADE • STRAIGHT EDGE
- BURNISHING TOOL PLUS PROTECTIVE SHEET OF PAPER
- PALETTE KNIFE • OPTIONAL FINE, SOFT BRUSH • SOFT PAPER TOWELING OR RAG
- CONTAINER OF WATER FOR CLEANING BRUSH/PALETTE KNIFE & SOFTENING EDGES
- OPTIONAL COLOUR SHAPER TOOL WITH FLAT EDGE FOR SMOOTHING PRIMER
- EMERY BOARD AND/OR MEDIUM-FINE SAND PAPER (BOTH IS BETTER)



Ten Easy Steps for Splicing Colourfix Paper:

- 1- Trim edges to be joined
- 2- Apply adhesive & place first paper
- 3- Repeat for second paper
- 4- Burnish papers
- 5- Sand down seam
- 6- Apply Primer
- 7- Allow to dry 5 to 15 minutes
- 8- Sand Primer
- 9- Apply more Primer, dry & sand, repeating steps as needed
- 10- Finish by rolling on increasingly wider, thin applications of Primer

COMPLIMENTS OF

*Art Spectrum Artists' Materials
and Armadillo Art & Craft*

PO Box A, Belle Mead, NJ 08502

Ph: 908.874.3315 Fx: 908.874.5433

Email: info@armadilloart.com

THESE 10 SIMPLE STEPS ARE MORE FULLY EXPLAINED AND ILLUSTRATED BE-

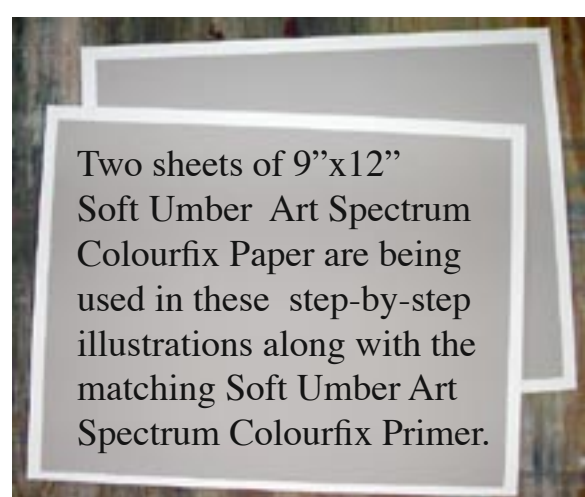

Two sheets of 9"x12"
Soft Umber Art Spectrum
Colourfix Paper are being
used in these step-by-step
illustrations along with the
matching Soft Umber Art
Spectrum Colourfix Primer.



1a: Be sure to use a straight edge longer than the edge you'll cut. Line up your straight edge carefully.

1b: Begin by trimming the white border off of each sheet of paper on the side you will be joining. Use a very sharp, fresh blade and cut very straight, clean edges.

2a

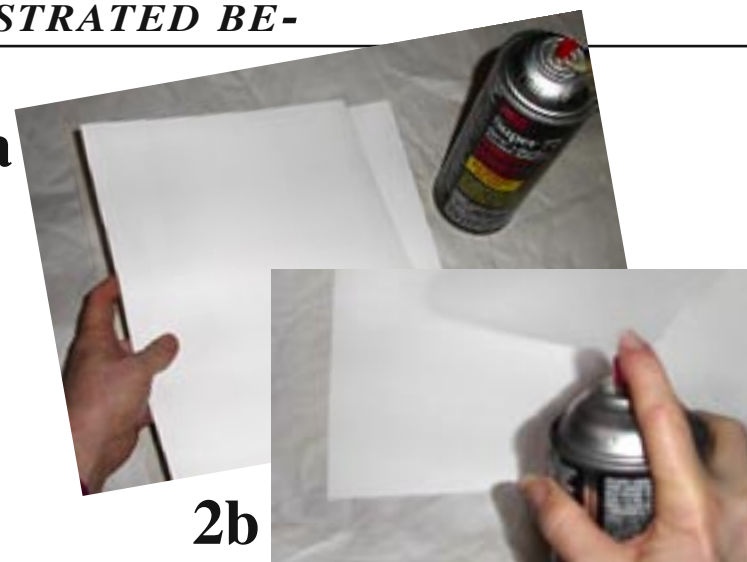

2b

2a: When working with two papers of the same size, you can stack them face down on each other on a large sheet of newsprint, etc. to protect your work surface from the adhesive. We're using 3M's Super 77 in this demonstration.

2b: Spray very evenly and generously.

• *Have ready your backing board, several inches larger than the finished size of your two spliced Art Spectrum Colourfix papers.*



2c

2c: If you are expanding a painting already in progress, you will want to place the painting first, adding the smaller section last.

Place the first piece of paper covered with adhesive onto the backing board, giving yourself even borders around three sides, leaving room for the second piece of Colourfix to be added next.

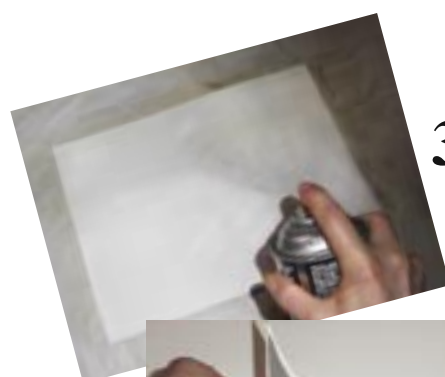

3a



3b

3a: Spray the second piece of Colourfix.

3b: Place the second sheet very carefully, pressing the two edges absolutely against each other, allowing only the joining edge of the second paper to touch the backing board. When in place, lower the rest of the paper onto the backing board.

4a



4b



4a: Using a piece of typing or printer paper to protect the Colourfix surface, burnish the sheet to the board to create a firm, even bond.

4b: Burnish the Colourfix edges carefully, as well. A firm brayer could also be used for this.



5

• *Primer is lighter when wet.*

5: Sand down the seam of the two papers. An emery board is an excellent sand-paper for working in a very narrow area, disturbing as little surrounding paper as possible!



Page 2 of Step-by-Step Picture Guide to Seamlessly

Splicing Art Spectrum Colourfix Papers

by Donna Aldridge PSA M-MAPS©2003



6a

6a: Apply a thin, narrow layer of Art Spectrum Colourfix Primer to the joint. A palette knife is very useful for this, handled much like a trowel.

6b: A fine-haired brush may also work well for you in applying Primer.

6c: Always keep a container of water to wash out your brush or palette knife immediately because the Primer is designed to dry quickly!.

6d: After you've applied a layer of Primer, you may want to smooth it out by running your finger tip over it immediately. You can also use the flat edge or face of your palette knife while the Primer is wet.

6d

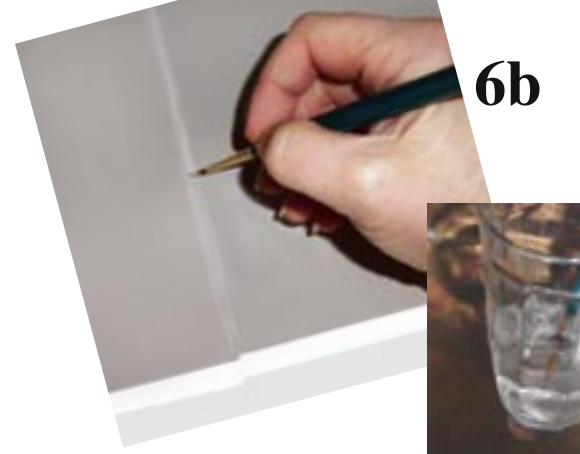

6b

6c



6e: Another excellent tool for smoothing the Primer is one of the Colour Shaper tools. Pictured here and on page one is a Wide Flat Firm 1 1/2" style.

6e

• *Keep the joint's seam as smooth, level and narrow as possible!*



7: Allow Primer to dry 5 to 15 minutes, longer with the first application



7

8a: This is what your joint's seam should look like after the first layer of Primer has been applied, taken 10 to 15 minutes to dry and then lightly sanded.

8a

8b: In addition to using an emery board you can achieve a narrow sanding surface by folding sandpaper as shown.

9a: Add another layer of Primer.

9b: Another smoothing technique, beginning with the second or third layer, is to dampen the edges with a wet cloth to taper it out.

9a

9b



9c

9c: Repeat steps as needed.

10a: You may want to begin using a fine sponge roller to distribute the Primer now. The line of Primer can get a little wider each time, however, still narrow, 1" or less at this stage.

10a

• *How smooth you need or want the finished effect will depend on your style of painting, etc.*

10b. Last stage: apply wider areas of Primer with the fine sponge roller, spreading it out over a broader area.

10c: Once you've evenly distributed the fresh Primer sideways, begin rolling across the joint's seam. Roll over and over to produce an ever-finer surfacer.

10b

10c

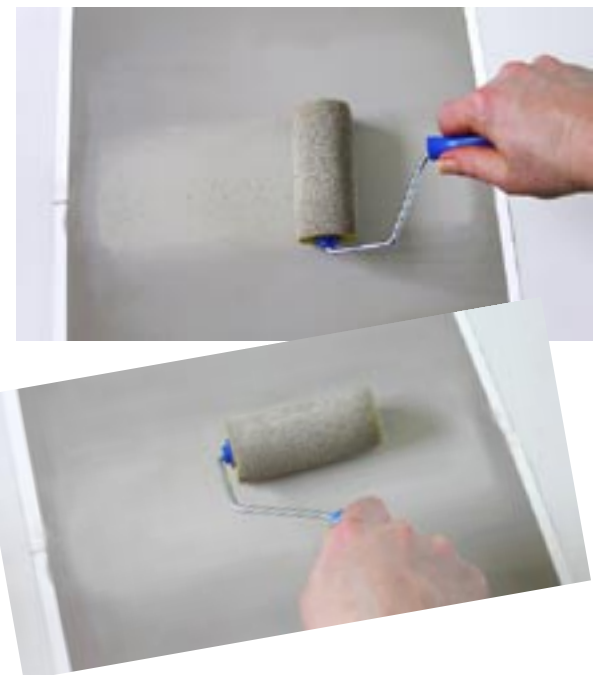

10d

10d: *Finished!* You'll know when you have sealed the joint to your own satisfaction. And, as with other art projects, you'll gain more skill each time you go through these steps.

Among many other uses for combining Art Spectrum Colourfix Paper and Primer:

- *salvage a ruined area, heavy with pigment and fixative: sand, overpaint with matching Primer*
- *brush Primer onto Paper in certain areas to add texture to surface in matching or other colors*
- *wash on Primer of different hue to vary the color of paper but keep surface texture constant*

Colourfix Paper can be sanded slightly or considerably for velvet or velour textures!

Primer can be painted onto watercolor/etching papers, wood or masonite panels of any size!